

(Verbesserte) Clinchknoten

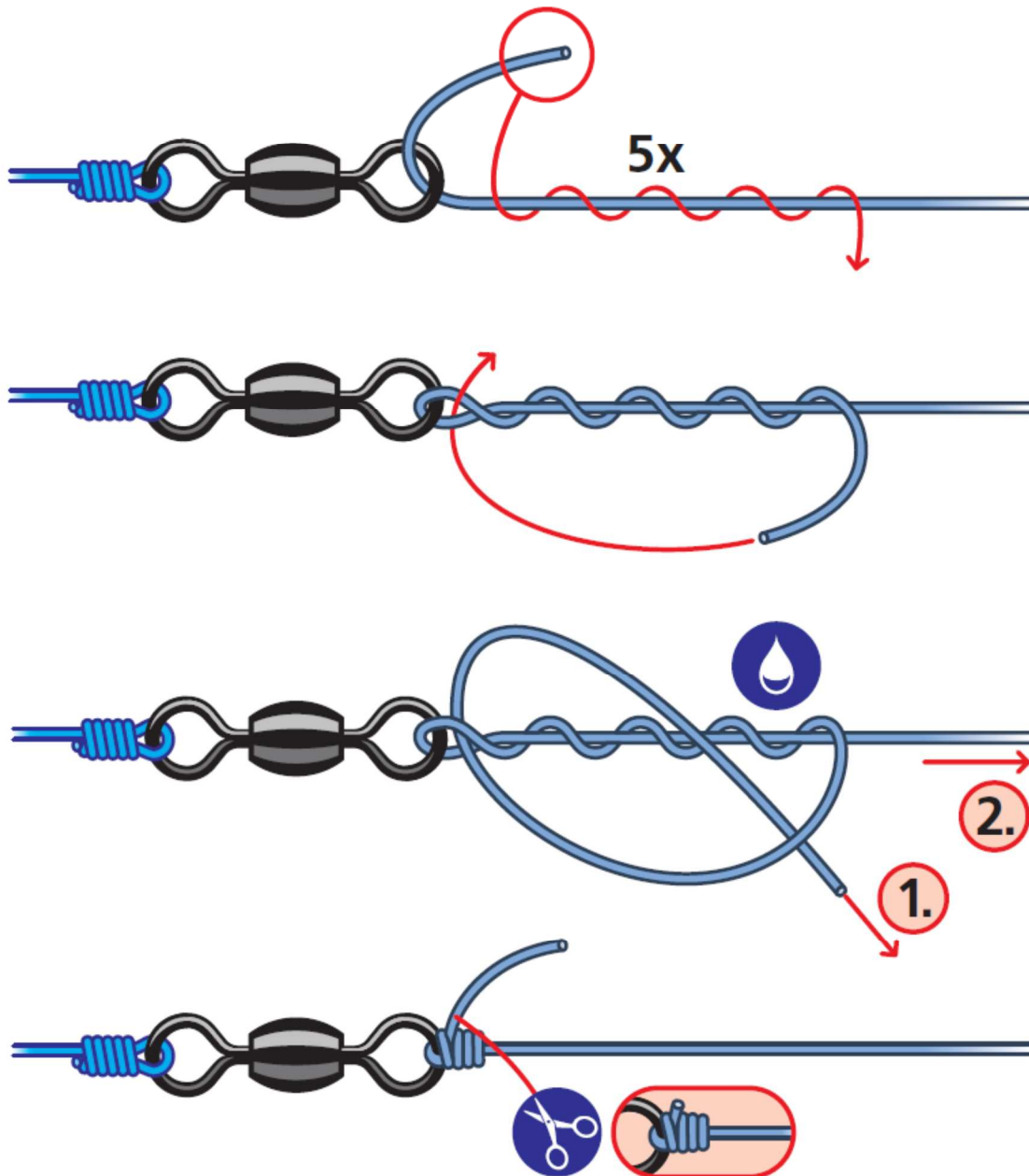

Uniknoten (Grinnerknoten)

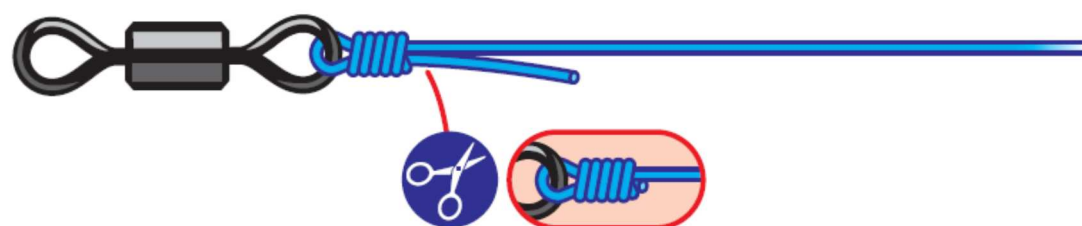
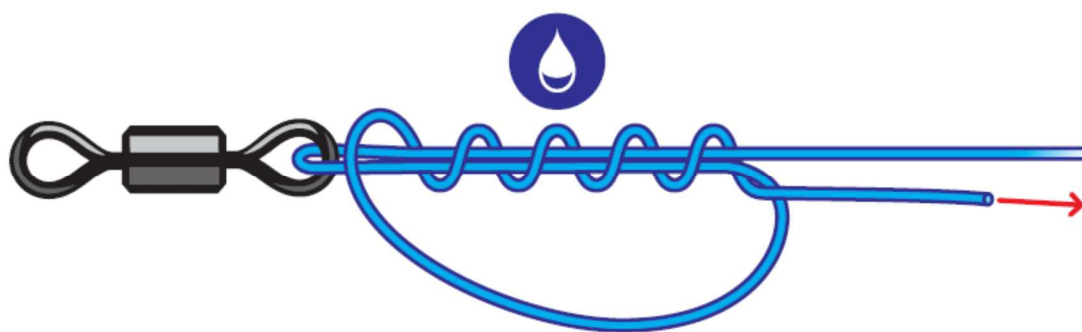
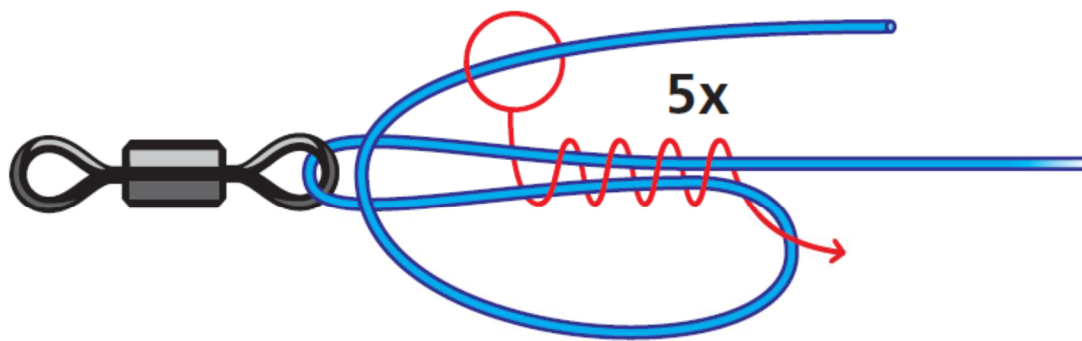

Palomarknoten

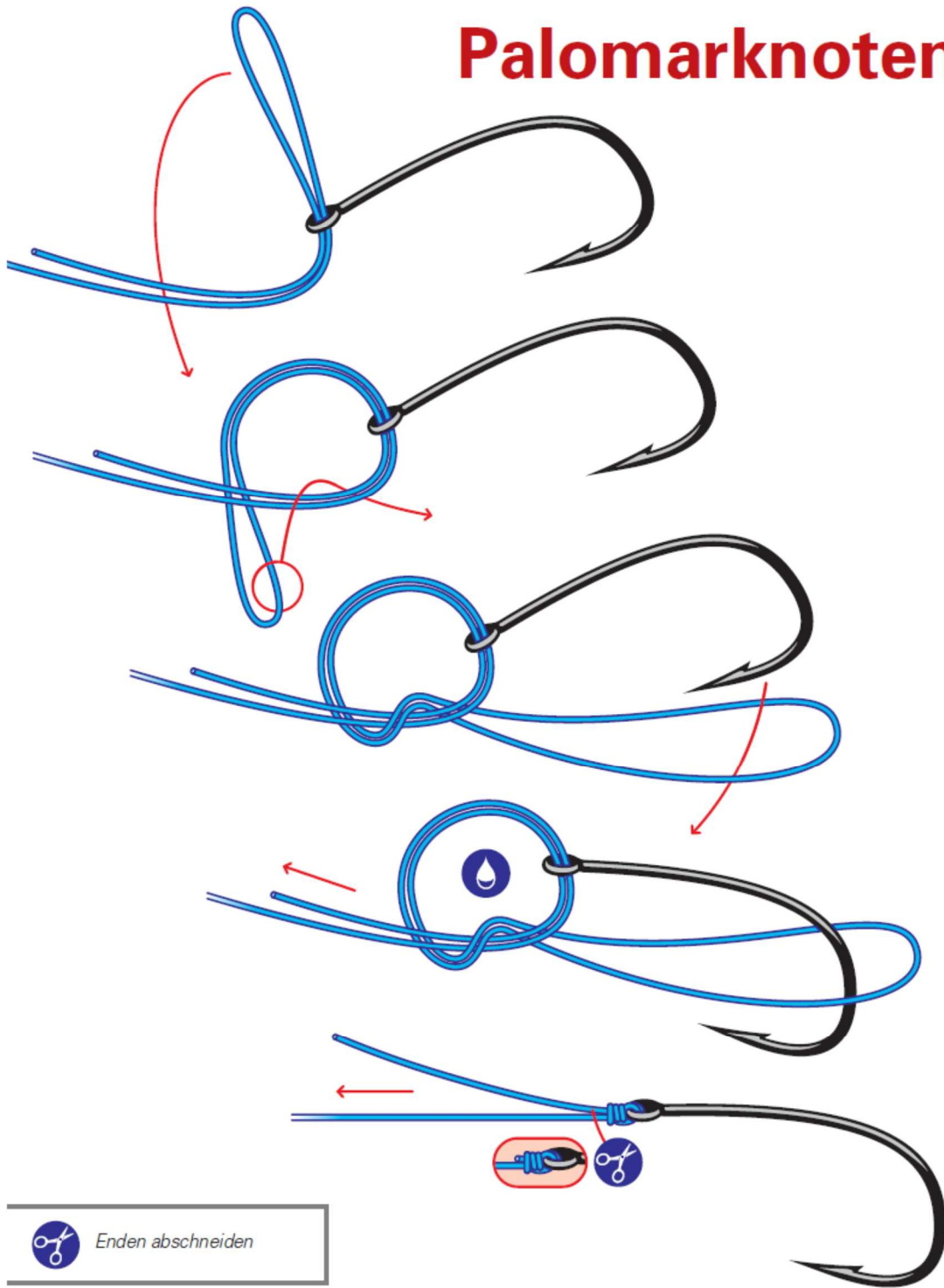

Clinch mit Doppelschnur

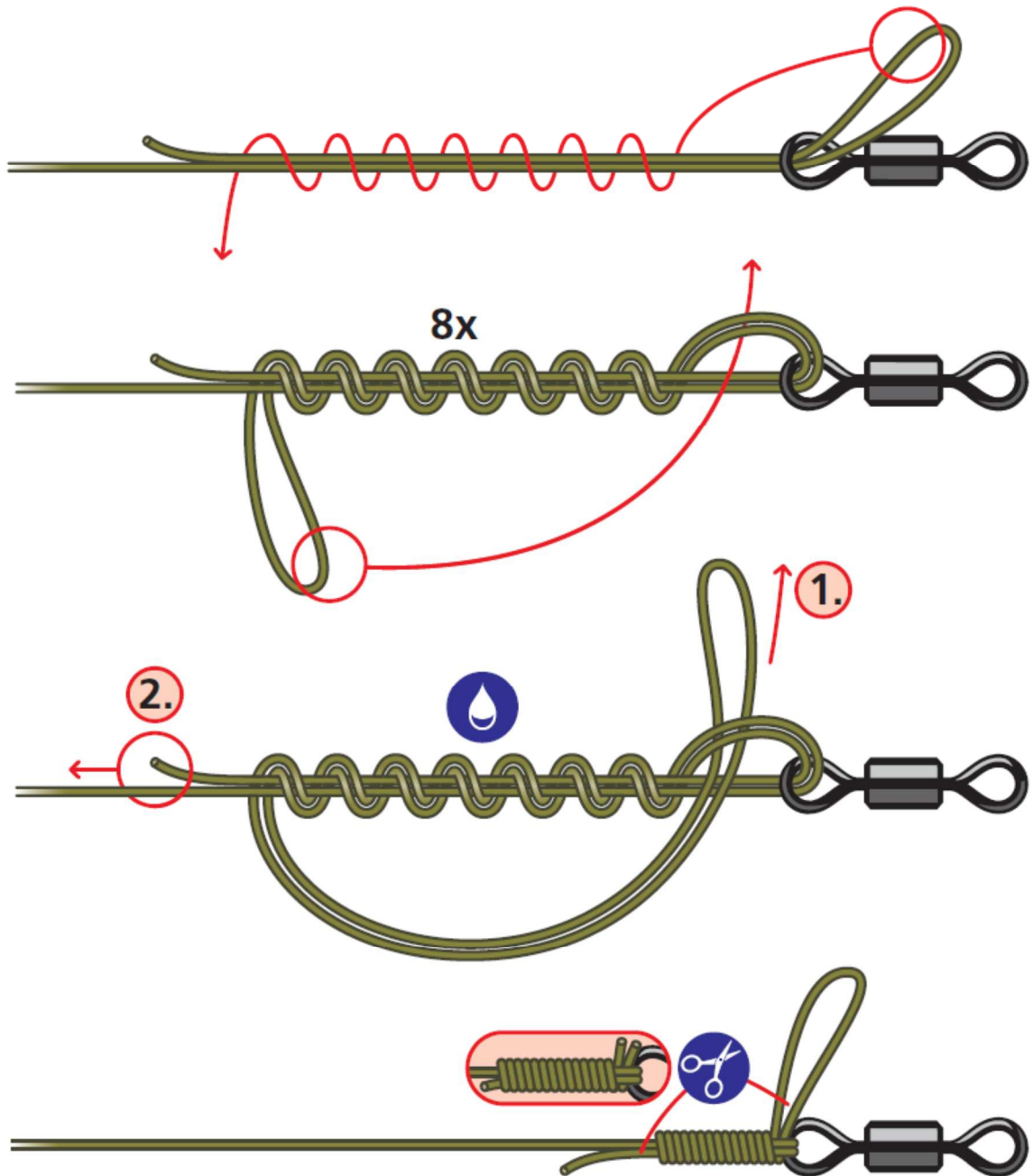

Rapala-Knoten

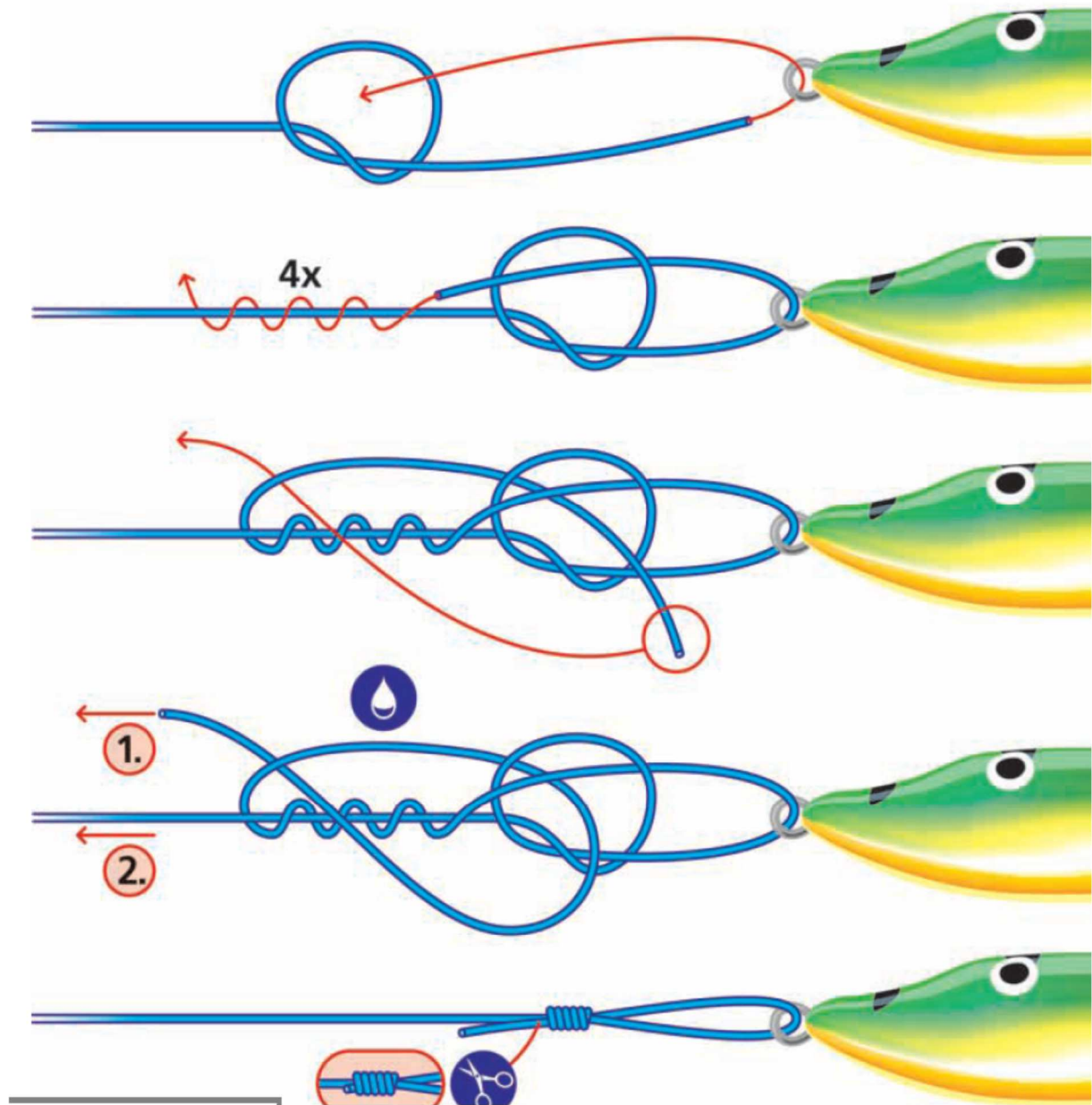

Doppelter Grinnerknoten

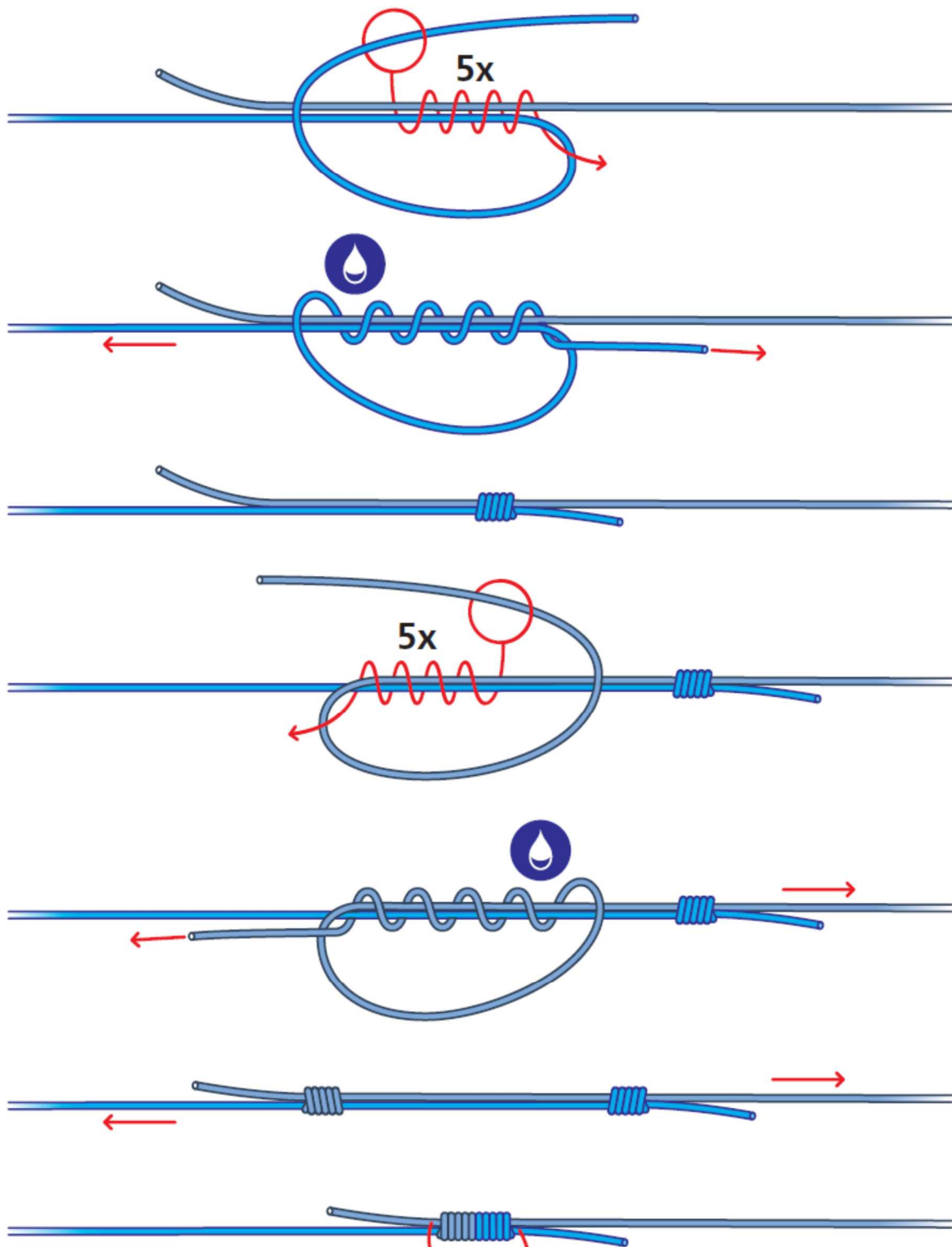

(Verbessertes) Albright-Knoten

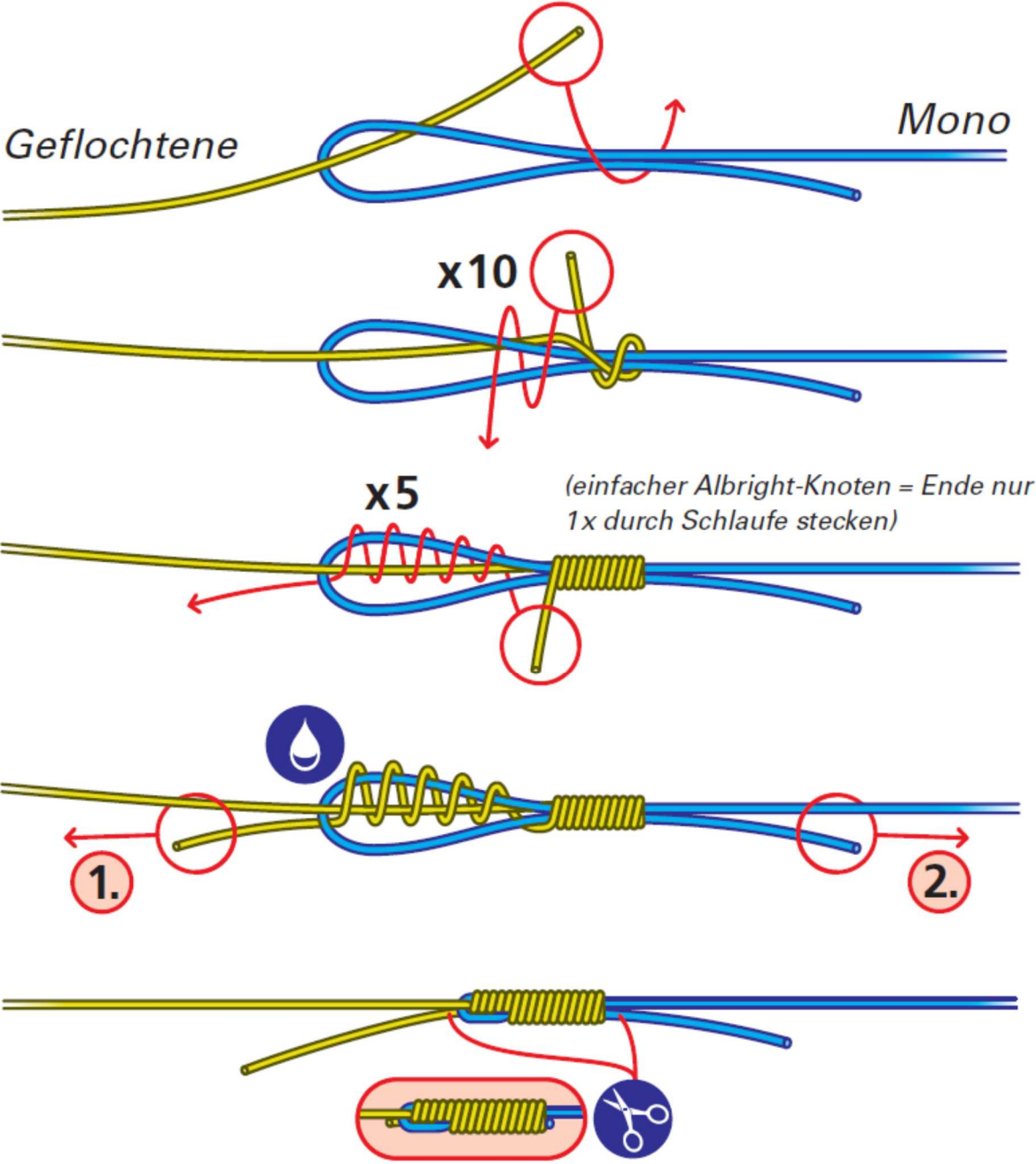

Schlaufenknoten

Wenn man diese Schlaufe groß genug formt, bildet sie die Grundlage für eine Paternoster-Montage. Die Schlaufe wird im Verhältnis 2:1 aufgetrennt, an das längere Ende kommt das Vorfach, an das kürzere das Bodenblei bzw. der Futterkorb.

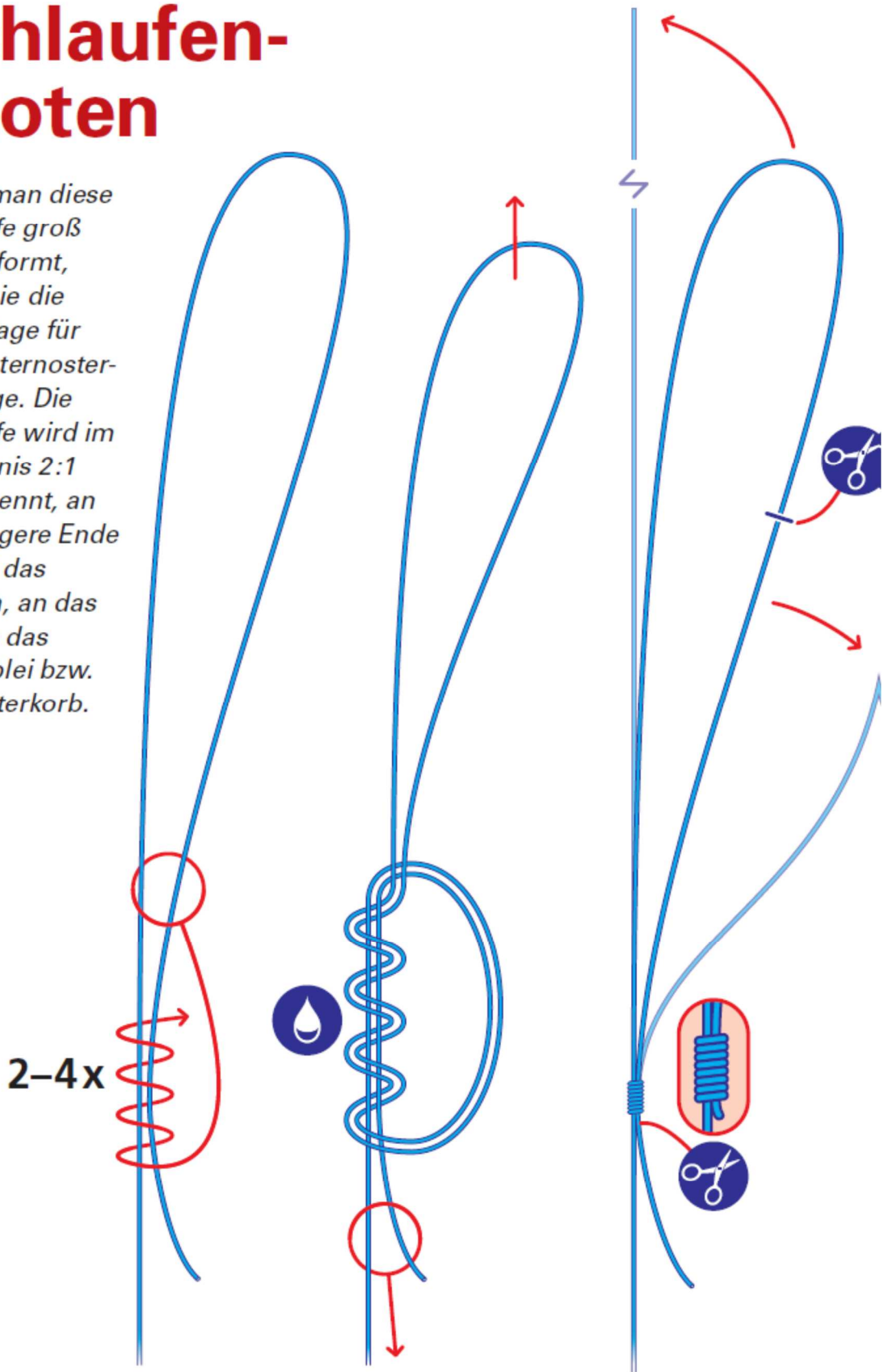

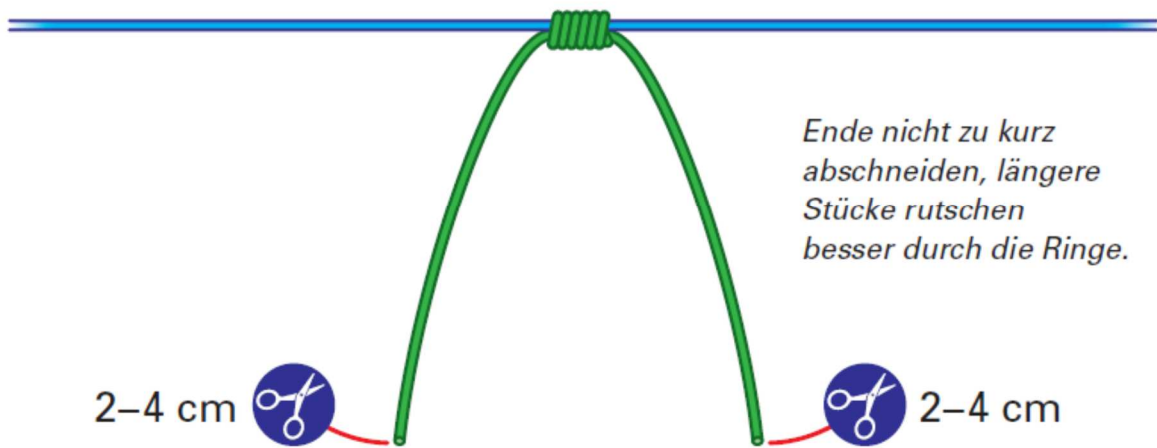
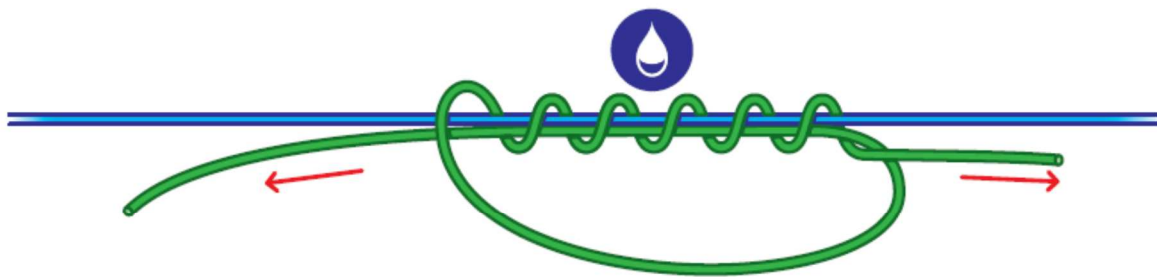
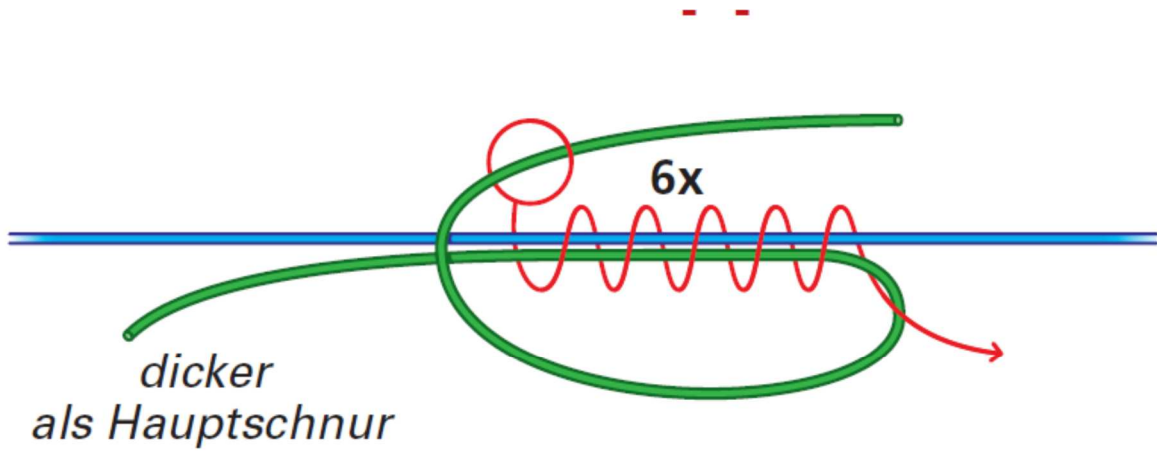

Knoten für Plättchenhaken

Knoten 1

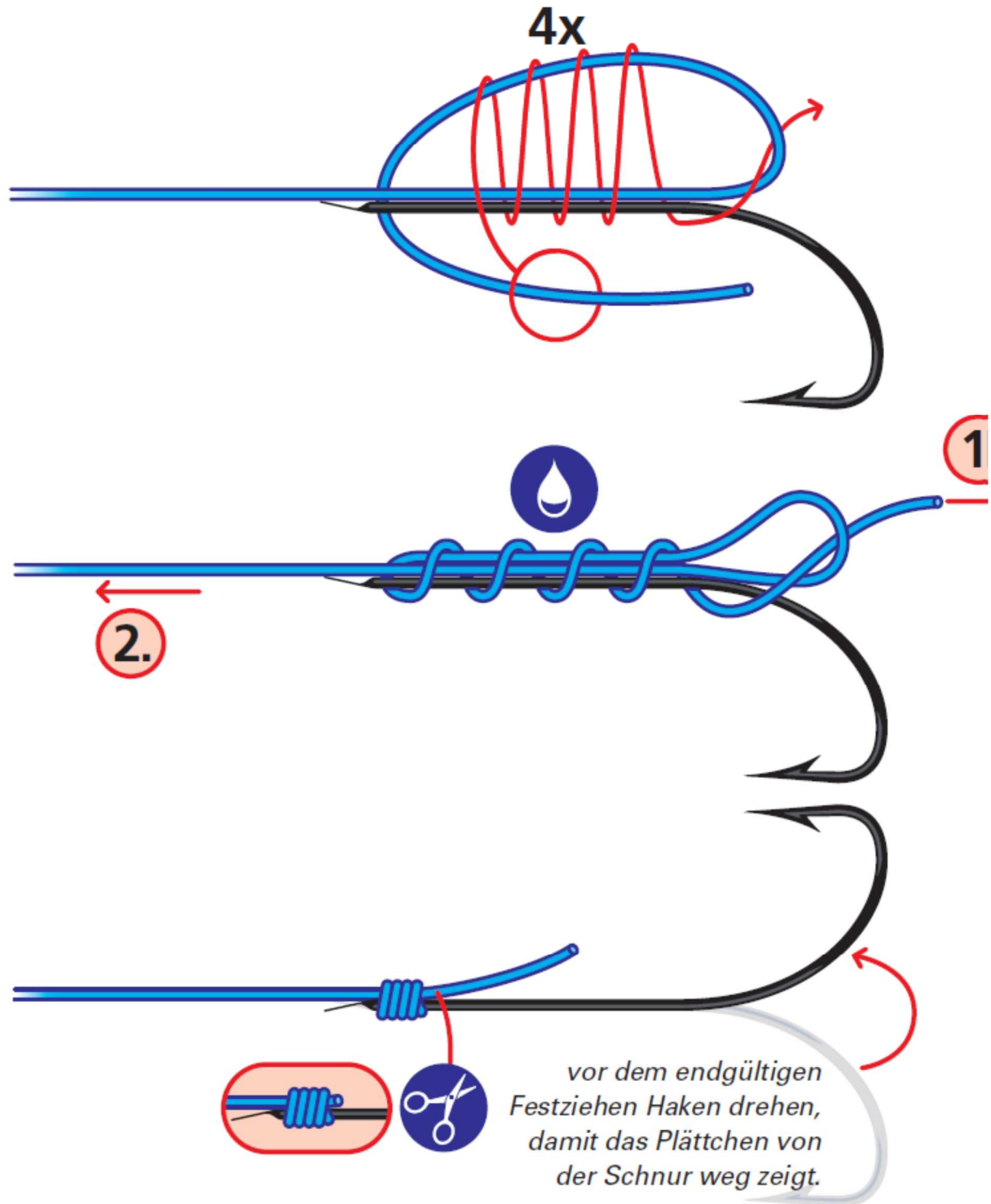

Knoten 2

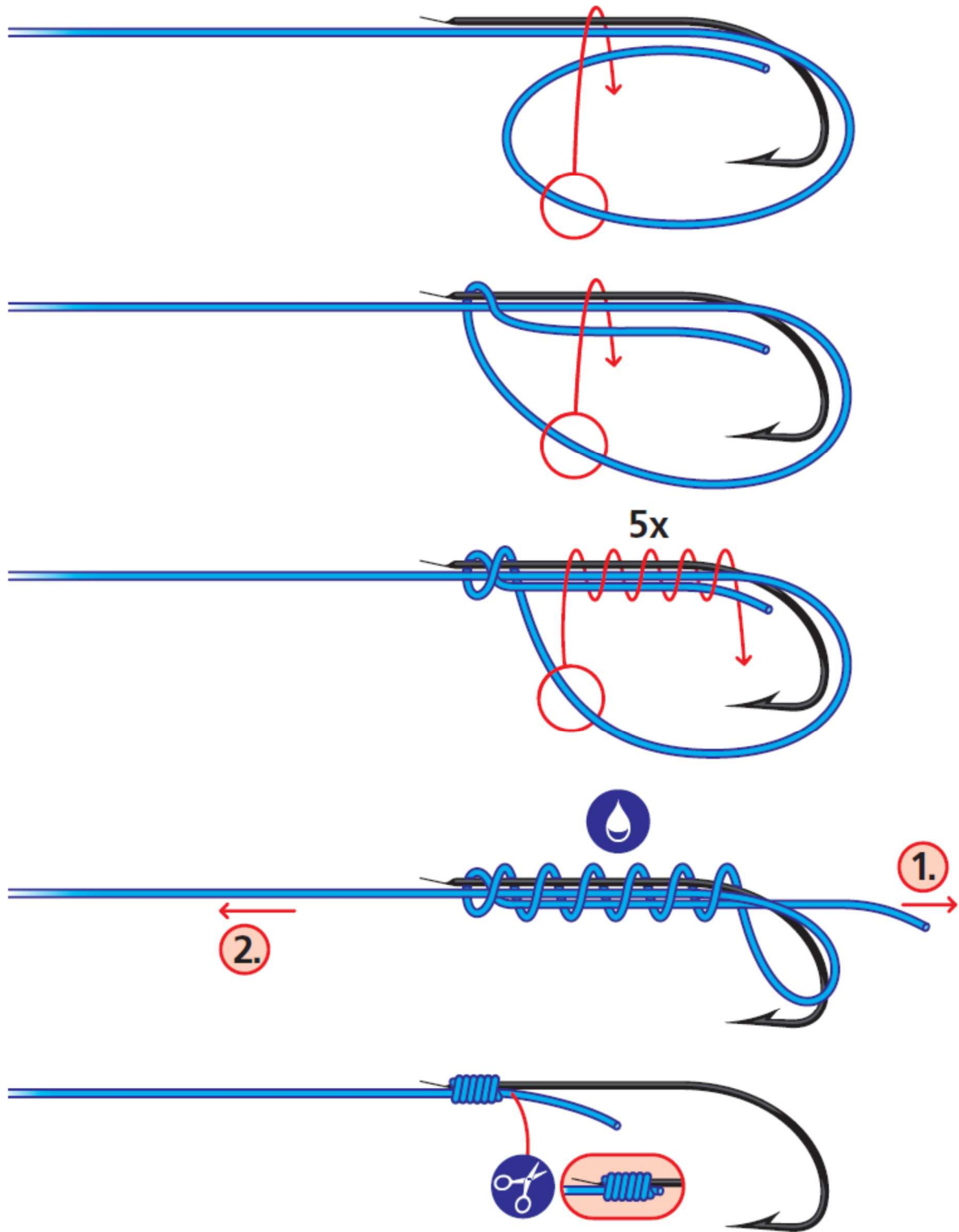

Knoten für Kopfruten-Gummi

Elastik-Knoten

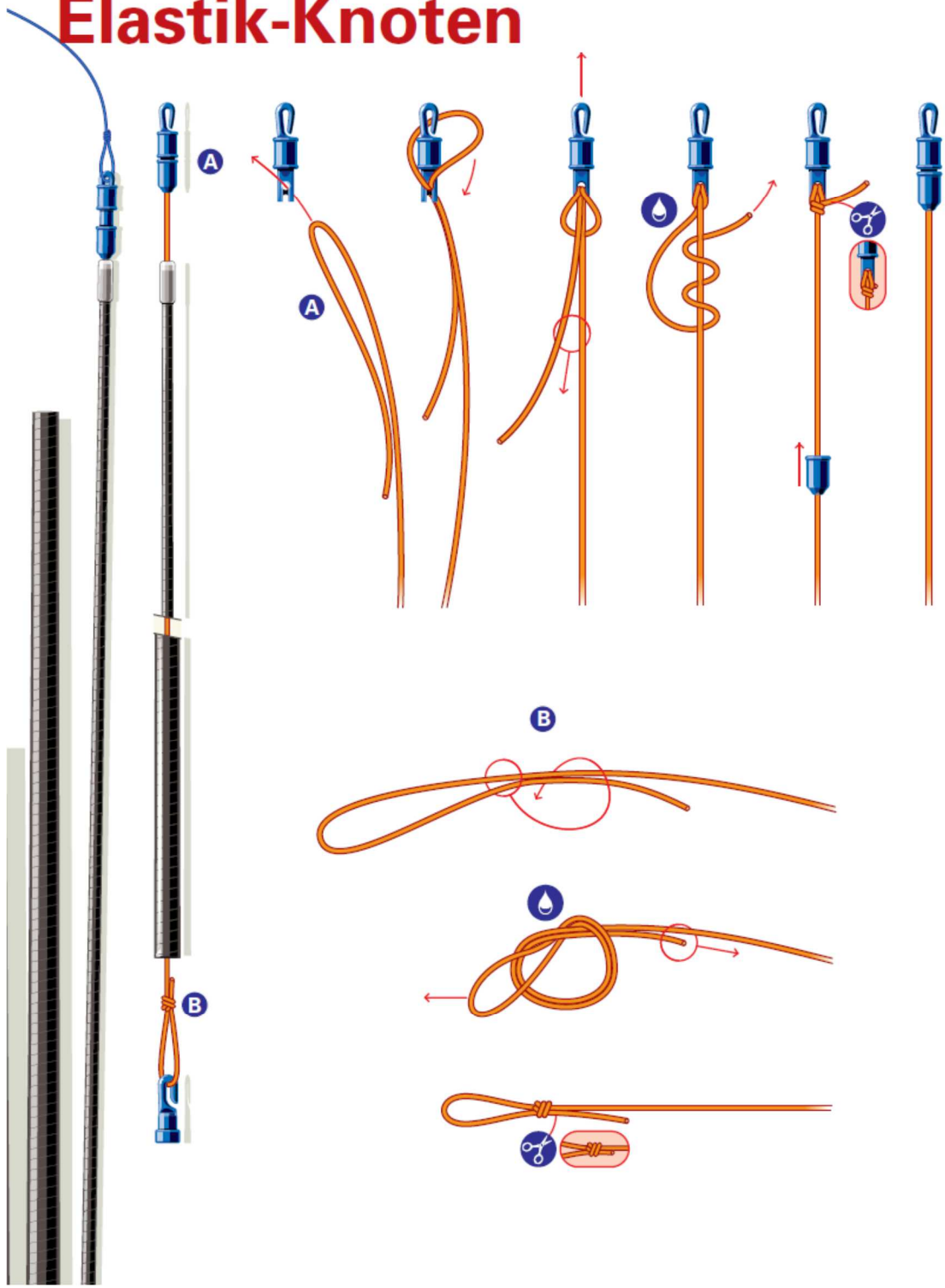

Hauptschnur-Vorfach

Schlaufen-Verbindung

